

Staff Building Options

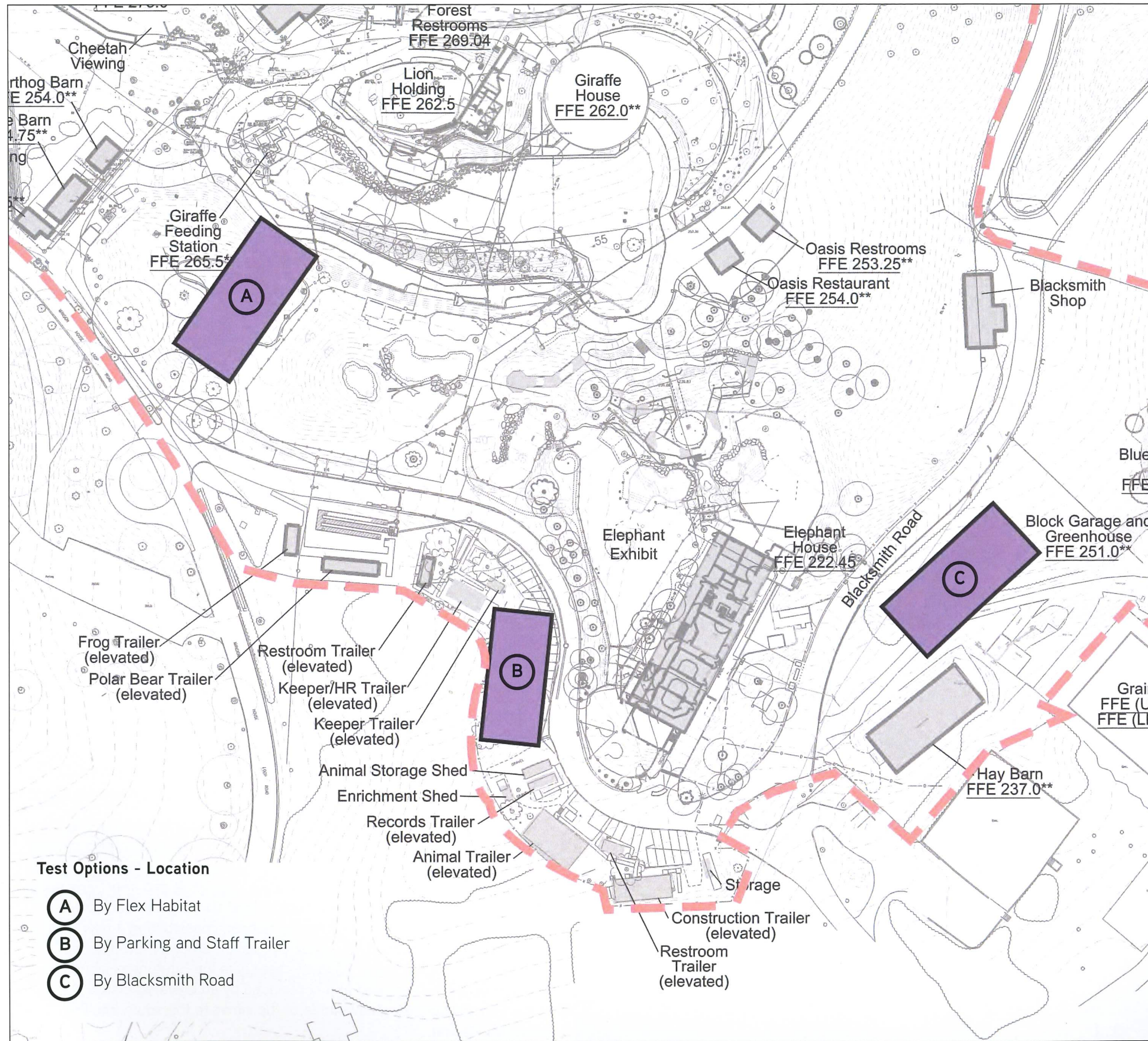

Test Locations

Site A is a relatively small parcel of land adjacent to the western edge of the Elephant Habitat. It is accessible from a service road that follows the southern edge of the Zoo. A building in this location will be visible to the public from the main habitat path below the Giraffe Feeding Station. A building on two levels was tested for this site. A natural drainage way cuts through the middle of the site. This drainage way has been modified over the years with various projects. East of the African Watering Hole holding building is a constructed wetland that will impact how and if the site can be developed.



Site B is located west of the existing Elephant Holding building and south of the Keeper / HR trailer. This location is not accessible from guest paths and a building in this location will be mostly hidden from guest view. A building in this location can be accessed from the Mansion House Drive and the Shop Road based on future design of the building and staff parking. A section of the Zoo perimeter fence parallel to the Shop Road will need to be modified to make this site an option. Based on existing grades in this area, a building on two levels will work very well. Shops and work spaces can be located at the lower level and staff areas can be located at the upper level.



Site C is located northeast of the existing Hay Barn along Blacksmith Road. This location is not accessible from guest paths and a building in this location can not be seen from guest paths or viewing areas. This site is located within the Pristine Forest zone. The site has been modified over the years and has been used for Zoo storage. Based on existing grades in this area, a building on two levels will work well similar to option B.

Staff Support Building and Events

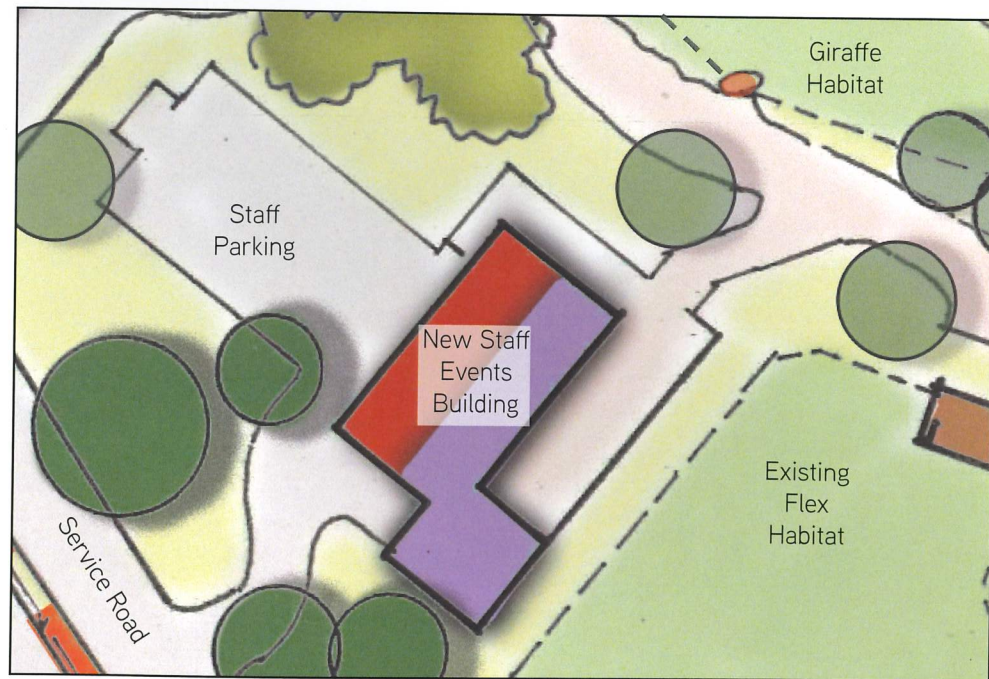
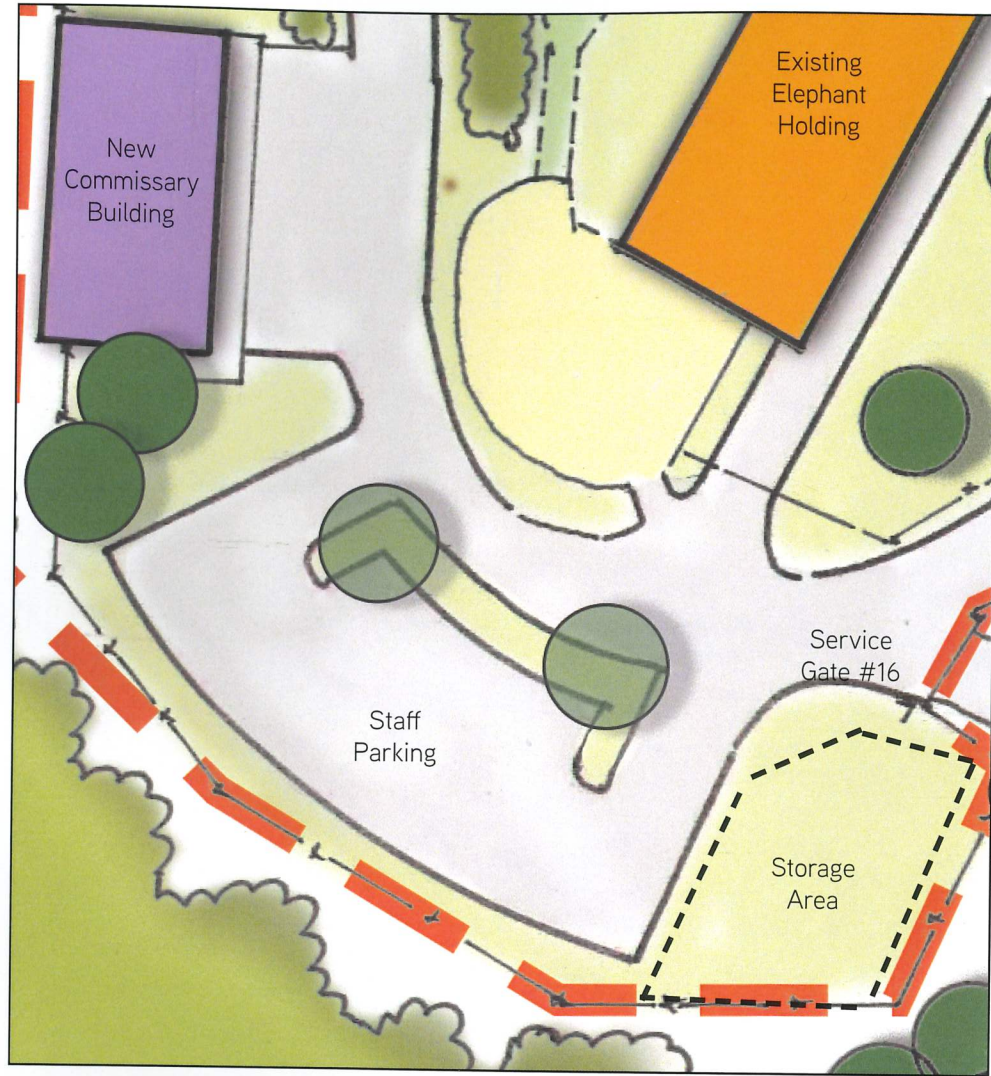

SCALE: 1" = 60'-0"



Several Zoo Support functions that include animal staff, human resources (HR), staff restrooms, and enrichment storage are currently in twelve old trailers located on the south and west side of the Elephant Habitat and off-exhibit yard. The combined space is approximately 8,000sf. The intent is to eliminate all of the trailers over the next five to ten years.

Several locations were tested and three locations were selected by the team to explore further. Each site has constraints that will need to be addressed during future design phases.

Below is a test diagram developed for Option A. This is a building with split functions on two levels located along the west edge of the main Elephant Habitat. The lower level is dedicated to animal staff while the upper level can be used as meeting and event space overlooking the Elephant Habitat. The building, as shown, is around 10,000sf with some staff parking behind the building. Also proposed is an additional commissary building with increased refrigeration capacity.

